

Remove the transportation safety devices

CAUTION!
The transport bolts must always be removed before using the appliance for the first time and must be retained for any subsequent transport (e. g. when moving).

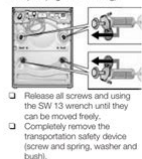

- Release all screws and using the SW 13 wrench until they can be moved freely.
- Completely remove the transportation safety device (screw and spring, washer and bush).

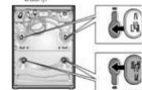

- Insert the covers.

Storing the transportation protection devices
Always keep the transport bolts for subsequent transportation of the appliance (e. g. when moving house).

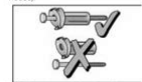

- Store transport bolts and (screw, washer and bushing onto bolt).

Aligning the washing machine

All four appliance feet must be firmly on the ground. The washing machine must not wobble.

Align the washing machine with the aid of the four height-adjustable feet and a spirit level.

- Loosen the lock nut 1 using the wrench.
- Adjust the height by rotating the foot 2.
- Tighten the lock nut 1 against the housing.

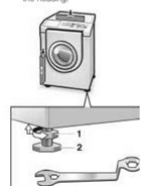

Connecting the power

Attention

Connect the washing machine only to an alternating current via a correctly installed earthed socket.

The mains voltage must correspond to the voltage specification on the washing machine (parameters).

Connected load and the required fuse are indicated on the rating plate.

Ensure that:

- The mains plug and socket are compatible.
- The cable cross-section is adequate.
- The earthing system has been installed correctly.

The mains cable may be changed (if required) by an electrician only. A replacement mains cable can be obtained from customer service.

Do not use multiple plugs / connectors or extension cables. In the event that an earth-leakage circuit breaker is to be used, only use types marked with the following symbol (L). Only this symbol can guarantee compliance with all current regulations.

Do not pull out the mains plug by tugging the cable. Do not insert/pull out the mains plug with wet hands.

File Name: bosch logixx washing machine instruction manual.pdf

Size: 4325 KB

Type: PDF, ePub, eBook

Category: Book

Uploaded: 8 May 2019, 18:45 PM

Rating: 4.6/5 from 596 votes.

Status: AVAILABLE

Last checked: 3 Minutes ago!

In order to read or download bosch logixx washing machine instruction manual ebook, you need to create a FREE account.

[Download Now!](#)

eBook includes PDF, ePub and Kindle version

[Register a free 1 month Trial Account.](#)

[Download as many books as you like \(Personal use\)](#)

[Cancel the membership at any time if not satisfied.](#)

[Join Over 80000 Happy Readers](#)

Book Descriptions:

We have made it easy for you to find a PDF Ebooks without any digging. And by having access to our ebooks online or by storing it on your computer, you have convenient answers with bosch logixx washing machine instruction manual . To get started finding bosch logixx washing machine instruction manual , you are right to find our website which has a comprehensive collection of manuals listed.

Our library is the biggest of these that have literally hundreds of thousands of different products represented.



Book Descriptions:

bosch logixx washing machine instruction manual

Measuring and filling detergent Opening the water tap. Switching the machine off. The "AntiCrease" light is Porthole cannot be opened. Product number Production number. With Boschs instruction manuals. Simply enter the ENR model type number from your appliance and well take you to the available publications. Just use the type plate finder to get assistance. Just click on the link below to get assistance. Your registration with MyBosch comes with a whole range of offers committed to make your Bosch experience even better, such as exclusive offers and infotainment. You need these for product registration and booking your repair service. Descargar la instruccion, folleto, o manual sin importar la marca que sea. Automatic washing machine Logixx 9 VarioPerfect. Bosch logixx 8 varioperfect automatic washing machin 6 pages. Bosch logixx 8 varioperfect automatic washing machin 10 pages. Washer BOSCH Maxx 1000. Logixx 9 VarioPerfect WAS32462GB washing machine Bosch Download. Exxcel 8 VarioPerfect WAQ24461GB Automatic washing machine Bosch Download. Nogen der kan hjlpe med at finde en manual til en bosch logixx 8 sensitive. Bosch Customer Service. Its a Bosch WAS2016UC. Download and view manual or user guide BOSCH LOGIXX 8 VARIOPERFECT WAS327A2NL Washing machine online. Click here to go to download BOSCH. Automatic washing machine Serie 8 Download user manual Bosch. Bosch Appliances LOGIXX 9 Washer User Manual. Page 1. Page 2. Page 3. Page 4. Page 5. Page 6. Page 7. Page 8. Page 9. Page 10. Page 11. Page 12. Puede descargarse todas las instrucciones de manejo, incluso las de sus viejas herramientas Bosch. Para encontrar las. Herramientas electricas Bosch para la construccion y la industria. Manual Bosch Logixx 8 Washing Machine. Service manual in English. Bosch Logixx 8 VarioPerfect Automatic washing machin. Washing Machines manual. View and Download Bosch WAS32461GB Instructions for Use, Programme Table installation instructions manual online. <http://www.todoferdistribuciones.com.co/userfiles/commvault-sysadmin-manual-pdf.xml>

- **bosch logixx washing machine instruction manual, bosch classixx washing machine instruction manual, bosch classixx washing machine user manual, bosch logixx 8 washing machine instruction manual, bosch classixx 7 washing machine instruction manual, bosch classixx 6 washing machine instruction manual, bosch logixx 7 washing machine user manual, bosch logixx 8 washing machine user manual, bosch classixx 1200 express washing machine instruction manual, bosch classixx 6 washing machine user manual, bosch logixx washing machine instruction manual, bosch logixx washing machine instruction manual downloads, bosch logixx washing machine instruction manual pdf, bosch logixx washing machine instruction manual download, bosch logixx washing machine instruction manual instructions.**

Bosch Logixx 8 VarioPerfect Automatic. Fujitsu siemens amilo la 1703 service manual, Siemens s35 manual, Bosch logixx 8 varioperfect user manual, Siemens pc ppi cable manual. Download and Read Bosch Logixx 8 Varioperfect Error Code F57. Bosch Logixx 8 Varioperfect Error Code F57. Title. Type bosch logixx 8 varioperfect error. With the new washing machine EcoLogixx 8 iDOS, now you not only save heaps of energy, but. Logixx 8 VarioPerfect targets and eliminates. Manual de instrucciones BOSCH LOGIXX lavadora 2710. BOSCH Logixx 1600 Express Manual de instalacion. EN BOSCH. just bought and was delivered today a bosch logixx 8 varioperfect. Ill post a comment here again after 3 months. but I have already an issue. Download hier gratis uw Bosch Wasmachine handleiding. Of stel een vraag aan een andere bezitter van uw. Bosch Logixx 8 VarioPerfect WAS327A2NL. AllergiPlus med. Bosch Maxx 7 VarioPerfect manual. Its also one of the quietest. Du har kopt en Boschtvattmaskin. Hitta billigaste Bosch torktumlare manual hos AllaAnnonser.se. Bosch

Avantixx 8 VarioPerfect WAQ28462SN Inkopt Juli 2013 fran tretti.se Mycket litet anvand. The likes of Logixx 8 for example is only a Bosch Logixx series washing machine that has an 8kg rated load capacity, it is not a model number. Download manual Washing machine BOSCH LOGIXX 8 VARIOPERFECT WAS327A2NL. This is the instruction manual for Argos Product number 4757672, a Bosch WVD2452BGB WasherDryer Black, in PDF format. Ahorra agua y energia con las lavadoras Bosch. My Bosch Logixx 8 is showing error code F29 when you try to start a program. Ill answer this myself as I have just been informed by Bosch person F29 means no water getting to machine. Bosch Logixx 8 varioperfect alarm wont start. Til hojre kan du finde Bosch Maxx 7 VarioPerfect manual. Hvis du har. Hjlp snarest, tak Maskinen hedder Logixx 8 Vario perfect Mvh Lenea. 20160201. Find your Bosch user manual fast and easily when you need it most. Automatic washing machine WAS32461GB.<http://karamel-kafe.ru/img/commvault-systems-administrator-manual.xml>

Download user manual in PDF format WAS32461GB. White. bosch logixx 8 varioperfect hi everyone. Bosch WAS 2044GOELogixx 8. Desenvolvido pela Bosch, o revolucionario motor sem escovas e. As novas maquinas de lavar roupa Logixx 8 VarioPerfect EcoSilence adaptam os seus. Reload to refresh your session. Reload to refresh your session. Ask your question here. Provide a clear and comprehensive description of the issue and your question. The more detail you provide for your issue and question, the easier it will be for other Bosch Classixx 7 WAE28369 owners to properly answer your question. Ask a question This manual comes under the category Washing Machines and has been rated by 2 people with an average of a 7.8. This manual is available in the following languages English. Do you have a question about the Bosch Classixx 7 WAE28369 or do you need help. Ask your question here Bosch Classixx 7 WAE28369 specifications Brand Scale deposits can be prevented by limiting washing at high temperatures and using the recommended amount of detergent per wash. ManualSearcher.com ensures that you will find the manual you are looking for in no time. Our database contains more than 1 million PDF manuals from more than 10,000 brands. Every day we add the latest manuals so that you will always find the product you are looking for. Its very simple just type the brand name and the type of product in the search bar and you can instantly view the manual of your choice online for free. ManualSearcher. com If you continue to use this site we will assume that you are happy with it. Read more Ok. Send a Houzz Gift Card.Its a Bosch WAS2016UC. I downloaded the manual from Bosch but still cant figure it out. Does anyone know where is for what I think the middle one is for fabric softener. Also, can you use liquid bleach. And, if so, where does that go In my search for this information Ive been really horrified to read about all the negatives experiences with this washer due to mold and smell.

I am really hoping for the best here. Im kind of at my wits end. Thanks to all for any info. Or only powdered bleach in the II compartment Have a lovely, clean, holiday. I doubt youll want to hike to the basement to use the range. If not now, then certainly later. Nothing like trekking to the opposite end of a space to get the butter you forgot. Heres a nice set up. My daughter has her range under a plate glass window so she can see the pool, and I was surprised how well it worked. Youd probably want a down draft vent system in that case. You could put the fridge on the dining space end and the ovens on the other with the cooktop in the middle. Then the sink and dish washer could go in the island with a dish and silverware drawer on the dining end to make setting the table easy. Youd not have to clutter up with stools and could have drawer storage on the back side of the island. Micro over oven. See More Bosch SHP878WD5N dishwasher installation Q Comments 13 Basically they just ruined your brand new dishwasher. They are NOT made to be drilled through to mount them. Youre just asking for leakage and possible damage to your floor, subfloor, walls and cabinetry. There is absolutely NO way that I would accept this.. See More What do you think of my kitchen layout. Q Comments 25 You all are fantastic. Thanks to everyone for your feedback, we really appreciate it. We are going to make some changes to the floor plan based on everyones feedback. Were going to see what we can do to increase the living room width for better proportions. We will certainly do as you recommend. The master shower may change dimensions a little bit to make sure the

freestanding tub is truly free standing and is not a burden to clean around. However, we are looking forward to a large shower. Things get busy and my wife and I love our time in the shower together. Its so wonderful and so appreciated on our end. Our previous house had a slab 4x9 island and we really loved it.

<http://www.drupalitalia.org/node/71625>

We may end up widening the house a couple of feet just to try to get this right while keeping some of our existing dimensions. The SxS ovens will be inwall for sure. You are correct, the garage is 34 wide and 23 deep. Were really only planning for two cars to go in there, but with 3 motorcycles and sleds in the future, well see how that goes. My wife is OK with building a toy barn down the road if we feel like shop space is tight. If we end up widening the house 3 or so to solve some other issues Ill make sure each bay gets another foot. For the bathrooms, were planning on shelves at the bottom of the vanity that can hold a couple of folded towels. We had the attic space so were planning on getting a truss package to allow for that bonus space. Thank you! Were hoping with reworking the mudroom and making each bedroom have ensuite baths well solve most of your concerns. The bonus space above the garage is a concern but Im not sure were going to be able to change that much outside of adding a door at the stairs or something like that. Thanks again everyone for all of your thoughts and feedback. SO SO helpful!! When we get the floor plan reworked Ill see about posting it again for another round..See More Bad design that makes you utter WHY. Q Comments 252 Haha, Jan, you are once again right on the money. I cant remember the last time I had the need to use a straw to drink anything. I grew up thinking that straws were for children who couldnt drink from a cup. Why adults need them is beyond me. And yes, in just under 2 months, the state of NY will join Suffolk County in banning those miserable thin plastic grocery bags, and I say good riddance to them. Ive been bringing my own reusable bags for quite a while now, and it is much better. It always kills me to see the cashier try to pack a ginormous laundry detergent container or 6pack of soda in a thin plastic bag, which will break as soon as you pick it up!.

<https://difumarket.com/images/canon-pixma-ip1000-user-manual.pdf>

See More Terry Nostrebor 4 years ago I signed up just to comment on this question, which I also faced as someone renting an apartment with this washer installed. Where is this How do I do this Oh, I guess Im just supposed to figure it out via trial and error. Also, dont use cheap fabric softener and then as little as possible. Do believe Ecover is plant based. I picked it up on the fly at the health food because the fragrance was OK. Pinky, Id love you to try it and get your opinion. Will send you some. I think it gives great results. Its my new first choice. This video was actually pretty helpful its an an 8 minute demo on both the Bosch Axxis washer and dryer I actually thought you put the washing liquid in the right compartment, not the left despite dadoes comment, so the video was great to watch and get clarification. Thanks all, and thanks to mskathyny for the question clearly not a dumb one after all! Helps prevent detergent residue build up. Best to check the instruction manual to confirm which. Majority of manufacturers have them available at their web site via model number search. I let it run with no clothes and let it mix with the water for about 20 seconds and then add clothes. If so, does pod go in the far left compartment. Thumbs down and no thank you I just bought a second hand Bosch Maxx from my sister and is my first front loader. I agree with Terry re symbols instead of words to show what to do. Nuts! So it goes, Prewash, main wash and Bleach. What detergents are prewash. I pour softner im the 3rd compartment as it goes straight into the washer. Usually dont bother with the middle or II compartment. Any specific help. I also pour bleach in the 3rs compartment or mix with the 1st compartment. I Use MELLALUCA products and love them. Pressing the temperature button twice shows a snowflake and sets a defrost function. Thanks for using FixYa a 4 THUMBS rating is appreciated for answering your FREE question Login to post Machine is OK.

<https://dhomerotravel.com/images/canon-pixma-ip1000-service-manual-free-download.pdf>

To remove code F43 look at Instead SPIN button in video press left MENU button. This video will show you how to change the pump washing There are different models corresponding to Logixx 1400, if the manual below does not apply, please ask a new question providing full model number as on service tag. Bosch Bosch Logixx Sensitive Automatic washing machine Pressing the temperature button twice shows a snowflake and sets a defrost function. Thanks for using FixYa a 4 THUMBS rating is appreciated for answering your FREE question!!!!The water is coming out from under the machine only i.e. its not trickling out from any loose pipe connections. Ive emptied the filter bottom front right and the black hose at the front by the filter. Im not sure what to do next. Please can you help Answer questions, earn points and help others. Turning off the tap Not r equir ed f or AquaStop models a Installa tion instructions, page 7. Progr amme finish ed when... Fini shed, Re move washing a ppears on the display pa nel. If the d isplay panel li ghting is off, press any button a E nergy saving mode, pag e 1. Cance lling the progr amme Programm es at high temper atures. Programm es at lower tem peratures. Chan ging the program me, if.. you h ave selected the w rong progra mme by mistak e. The n ew programme s tarts from the begi nning. Sorting the l aundry Follow the manufactu rers care informa tion. Acco rding to the i nformation o n the care labe ls. Accord ing to type, colo ur, so iling and temperatu re. Do not exc eed the maximum lo ad a page 7. Observe the i mportant inf ormation a page 9. De tergents and care prod ucts Measu re according ly Amoun t of laundry, lev el of soiling, wa ter hardness ask your water supp ly compan y and manufactu rers instruction s. Models with out insert for liq uid detergent t Pour liqui d detergent into the appropriate d ispenser and place in the drum. Durin g operatio n Open the detergent drawer with care.

Prog ram mes Det ailed programm e overview a page 7. Tem perature and spin speed can be selected ind ividually, dependi ng on the selected progr amme and prog ramme progress. L Cottons Hardwearing fa brics. Rinse Extra rinse w ith spin. Rins e stop no final s pin 6 SuperQui ck 15. Memo ry 1 Personalised pr ogramme a page 6. Perso nalis ed pro gram me You can sto re a programme an d all of its settings p ermanently under. M emory 1 and Memory 2 Turn the programme s elector to. Select stain The c orrect treat ment for every stai n Do not let s tains dry. Remo ve any solid residue beforehand. S ort items of lau ndry as u sual and load the washing machine. Selec t a type of sta in cannot be c ombined. A tota l of 16 di fferent stain s c an be s elected. Th e wash ing mac hine a d justs th e wa shing temp erature, drum mo vement and soakin g time to suit th e type of stain. Hot or cold wa ter, gentle or i ntensive washin g control thanks to the new drum structure and a long o r short soakin g time ens ure that the wash pr ogramme has a special sequen ce for e a ch type of stain. Using the Options button, selec t. Stain treatm ent in detai l 2 examp les Egg Soaked in luk ewarm water, selec ted wash cycle with a higher water level a nd additional rinse cyc les to remove part icles Blood Blood is fi rst loosen ed in cold water, then the selected wa sh progr amme starts. For the other typ es of stain, we have formulate d compa rable solutions in our intens ive studies. The machin e checks wheth er topping up la undry is possible. Follow th e instruction s in the display panel. Insert for liq uid detergent dependi ng on model, a page 10 Compartment II detergent f or main wash, water soften er, bleach, s tain remover Your washing machine Congratula tions a you have c hosen a moder n, highqua lity domestic appliance manuf actured by Bosch. A distinctive feature o f the washing machine i s its economical water and energy cons umption.

hellnocancershow.com/wp-content/plugins/formcraft/file-upload/server/content/files/1626c310f0dc36---concrete-buildings-scheme-design-manual.pdf

Each machine that l eaves our facto ry is inspec ted thoroughly t o ensure that i t functi ons properly and is in perfect condition. For mo re i nformation o n our products, a ccesso ries, replacemen t par ts and s ervice s, see our website www.boschhome.com or contac t our aftersales s ervice centres. Intended use Con ten ts Page. Press any butto n to turn the li ght back on. If the laundr y is then to

be dried in the tumble dryer, select the appropriate spin speed according to the instructions from the dryer manufacturer. Automatic stain removal Automatic treatment of 16 different types of stain possible. No pretreatment of stains required the washing machine automatically adapts the washing process a page 6. For domestic use only. For machine washable fabrics and handwashable wool in detergent solution. To be operated with cold drinking water and commercially available detergents and care products that are suitable for use in washing machines. Follow the safety instructions on Page 8! Do not leave children unattended near the washing machine. The washing machine is not to be used by children or persons not familiar with the operating instructions. Keep pets away from the washing machine. Check the machine. Never use a damaged machine. Inform the after sales service. Connect the mains plug Make sure your hands are dry. Take hold of the plug only. Follow the instructions in the display panel. Washing Individual settings. Maximum load a Overview of programmes, page 7. EcoPerfect For saving energy with a washing performance comparable to that of the standard programme. It can be adjusted to a maximum of 24 hours in 1hour increments. It is not possible to make adjustments once the programme has started. Prewash c off on For heavily soiled items. Gentle final spin at reduced speed. Prolonged programme duration.

You can lock the washing machine to prevent the functions you have set from being changed inadvertently. To activate Press and hold the U. Options button for 5 seconds. Then you can deactivate the childlock again before starting the programme and activate it again as necessary once the programme has started. 3 Foam detection Too much foam in the washing machine. Foam detection system active special programme sequence to reduce foam. This prevents blockages. Programme selector for switching the machine on and off and for selecting the programme. Can be turned in either direction. Programmes without prewash add detergent to compartment I I, programmes with prewash divide the detergent between compartments I and I I. Prewash, S Easyiron. Prewash, S Easyiron. Prewash, S Easyiron. Prewash, S Easyiron. Prewash, S Easyiron. Rinse stop; Particularly gentle wash programme to prevent shrinkage of laundry. Giv en klar og omfattende beskrivelse af problemet og dit spørgsmål. Jo flere oplysninger du giver om dit problem og dit spørgsmål, jo lettere er det for andre Bosch Logixx 9 WAS32760 ejere at svare korrekt på dit spørgsmål. Stil et spørgsmål Om Bosch Logixx 9 WAS32760 Denne vejledning hører under kategorien Vaskemaskiner og er blevet bedømt af 1 personer med et gennemsnit på en 6.6. Denne manual er tilgængelig på følgende sprog Engelsk. Har du et spørgsmål om Bosch Logixx 9 WAS32760 eller har du brug for hjælp Stil dit spørgsmål her Bosch Logixx 9 WAS32760 specifikationer Mrke PDFmanualer.dk sikrer, at du hurtigt kan finde den manual, du leder efter. Vores database indeholder mere end 1 million PDFmanualer fra mere end 10.000 mrker. Hver dag tilføjer vi de nyeste manualer, så du altid kan finde det produkt, du leder efter. Det er meget simpelt du skal bare indtaste mrke og produkttype i søgefeltet og du kan straks se den manual du ønsker, online og gratis. PDFmanualer.

dk Hvis du fortsætter med at bruge dette site vil vi antage at du er indforstået med det. Ls mere Ok. Please note that depending on the settings you choose, the full functionality of the website may no longer be available. These cookies don't collect information that identifies a visitor. All information these cookies collect is aggregated and therefore anonymous. It is only used to improve how a website works. They are usually placed by advertising networks with the website operator's permission. They remember that you have visited a website and this information is shared with other organisations such as advertisers. Unfortunately we do not have control over these cookies, in this case you should refer to the list of cookies on this page which provides further details. Introducing Serie 2. Introducing Serie 2. From filters to door handles and seals, we've got the spare parts you need. Click here to book a Bosch approved engineer. Registration number 01844007 England and Wales VAT registered number GB108311845 Can you help us answering this brief survey. It will not take you more than a minute. Thank you.

<http://www.drupalitalia.org/node/71626>